

GAP60 GAP60CS GAP75
GAP100 GAP300

GPD

OPTOELECTRONICS CORP.

High Speed InGaAs Photodiodes

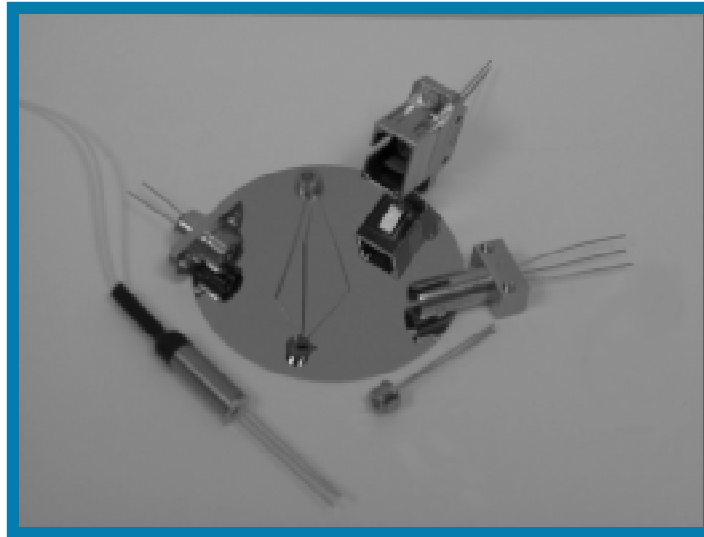

- **High Responsivity**
- **High Shunt Resistance**
- **Low Capacitance: High Speed**
- **Planar Design for High Reliability**

GPD Optoelectronics Corp.



Electrical Characteristics @ 25 °C

	GAP60/CS	GAP75	GAP100	GAP300	
Active Diameter	60	75	100	300	μm
Responsivity @ 850nm	0.10 (0.20)	0.10 (0.20)	0.10 (0.20)	0.10 (0.20)	A/W min. (typ.)
1300nm	0.80 (0.90)	0.80 (0.90)	0.80 (0.90)	0.80 (0.90)	A/W min. (typ.)
1550nm	0.95	0.95	0.95	0.95	A/W min.
Dark Current @ 5V	0.8 (0.3)	0.8 (0.3)	1.0 (0.5)	5.0 (1.0)	nA max. (typ.)
Capacitance @ 5V	0.7(0.5)/0.5(0.3)-CS	0.8 (0.6)	1.2 (1.0)	8.0 (4.0)	pF max. (typ.)
Bandwidth 50 Ω -3dB	2.5/4.0-CS	2.2	2.0	0.7	GHz min. @ 5V
Rise/Fall time $R_L=50\Omega$	0.07/0.04-CS	0.06	0.1	0.25	ns max. @ 5V
NEP @ 1550 nm	1.0E-15	1.0E-15	1.5E-15	5E-15	W/√Hz typ.
Case Style (standard)	TO-46(mod)/CS-1	TO-46(mod)	TO-46(mod)	TO-46(mod)	

Maximum Ratings

	GAP60/CS	GAP75	GAP100	GAP300	
Storage Temperature	-40 to 125	-40 to 125	-40 to 125	-40 to 125	°C
Operating Temperature	-40 to 85	-40 to 85	-40 to 85	-40 to 85	°C
Reverse Voltage	25	25	25	25	V
Reverse Current	1	10	10	25	mA
Forward Current	10	10	10	100	mA



GAP60 GAP60CS GAP75 GAP100 GAP300

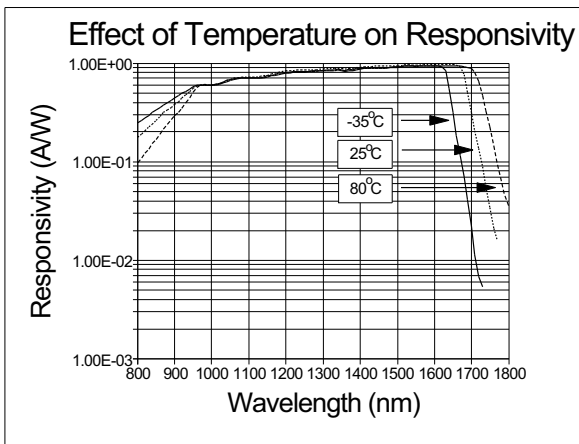
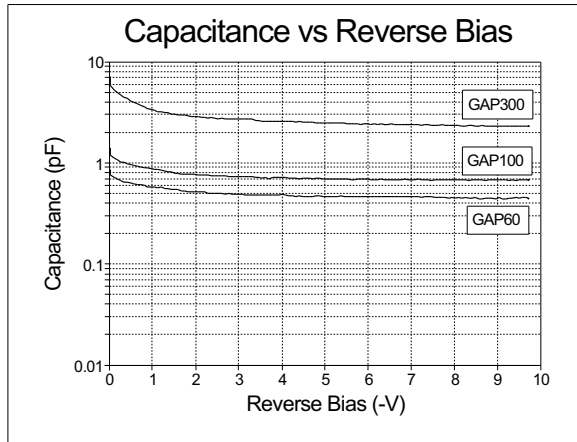
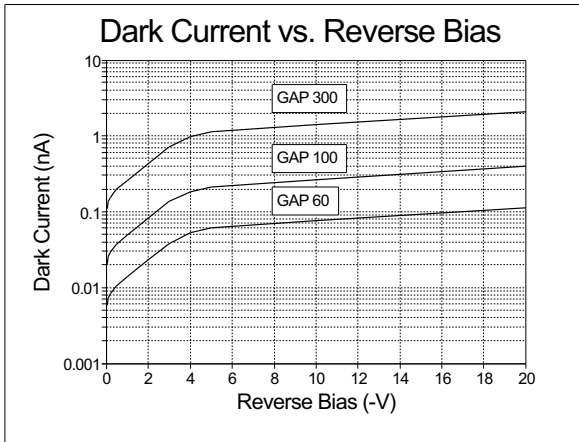

Package Outlines

Package Outlines

TO-46 (Modified)

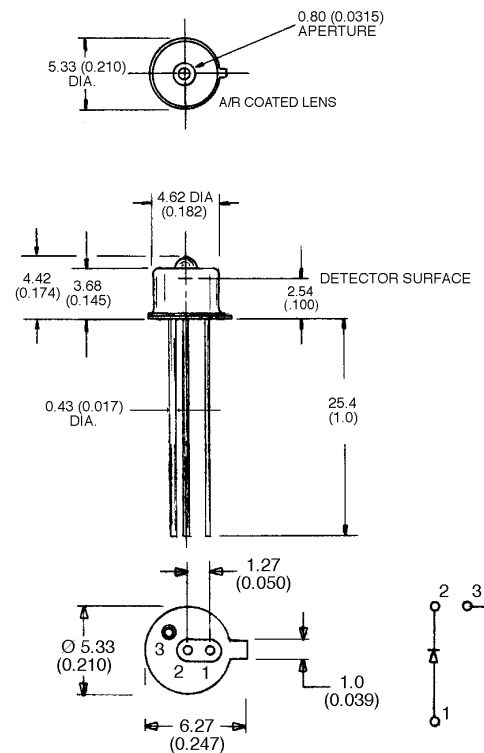

Package Outlines

"PT" Assembly

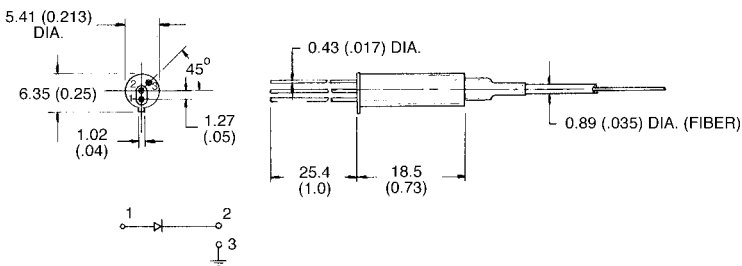

Dimensions in mm (in.) Custom packages are available

GPD Optoelectronics Corp.



Ceramic Submounts

Dimensions in mm (in.) Custom submounts are available.

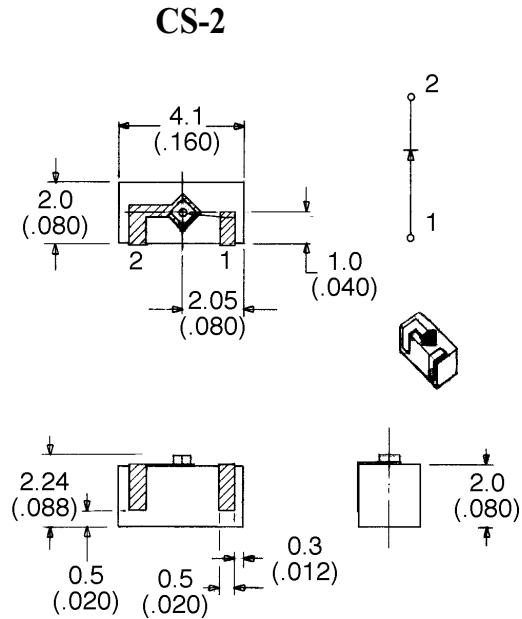
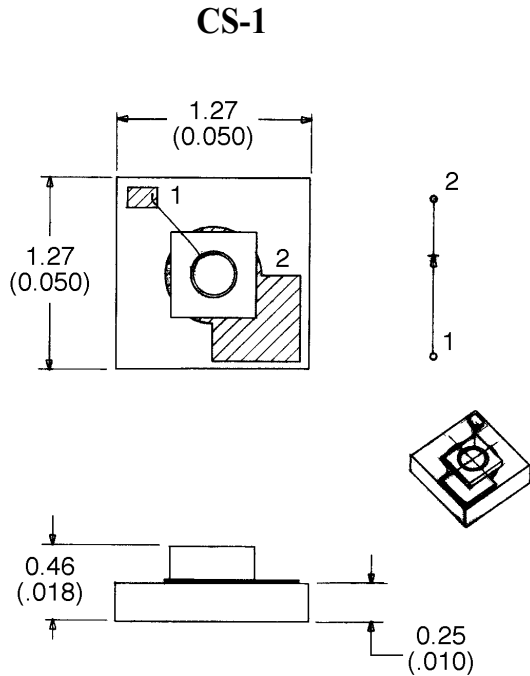

GPD Optoelectronics Corp. (formerly Germanium Power Devices) has been a manufacturer of power transistors and diodes since 1973 and a manufacturer of infrared photodetectors for more than ten years. GPD offers Germanium p-n, p-i-n, APD and InGaAs p-i-n high-speed and large area photodetectors for infrared radiation detection and telecommunications applications. GPD can offer you a photodetector that meets your technical and cost requirements.

GPD maintains an inspection system in accordance with MIL-I-45208. Photodiodes are subjected to Bellcore testing requirements(TA-NWT-00093), MIL-STD-883 test methods and/or customer specifications.

Nederland
Promis Electro-Optics B.V.
T +31 (0)24 648 86 88
info@gotoPEO.com
www.gotoPEO.com

België / Belgique
PEO Radiation Technology BVBA
T +32 (0)3 309 32 09
info@gotoPEO.be
www.gotoPEO.be